

Clyde H. Parker

Registered Land Surveyor and Professional Engineer

10405
Portland Ave. So.
Minneapolis, Minn.

Phone SO 1-7252

PLAT OF SURVEY

Scale 1 inch 30 feet

PROPERTY OF MR. John Monahan

6416 Wilryan Ave

Described as follows:

LOT 22

BLOCK 11

Normandale 2nd Addn.

Hennepin County, Minn.

6156
9879

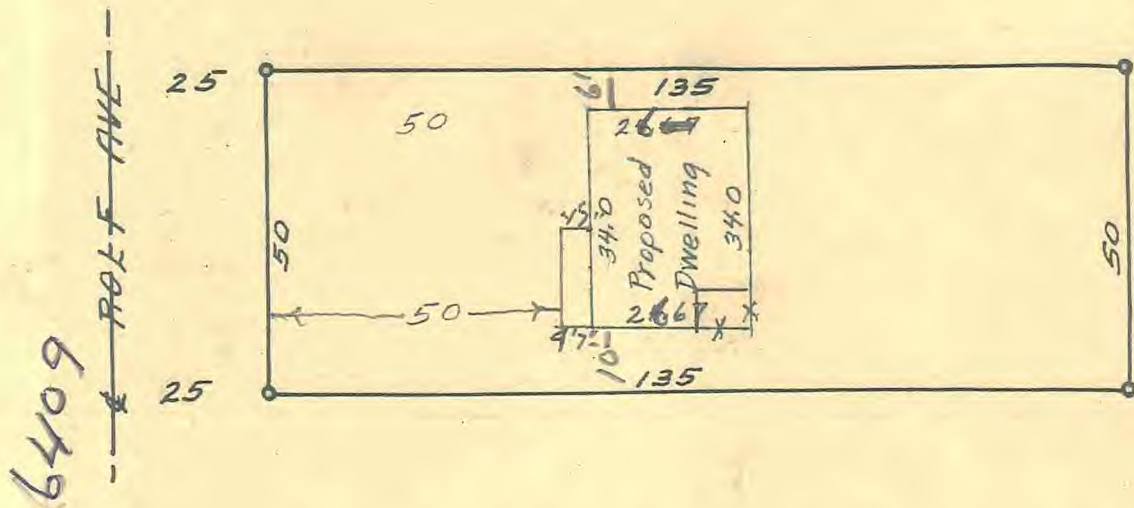

Note • denotes iron monument

04.116.21.23.0041
6409 Rolf Ave.

CERTIFICATE OF SURVEY

I hereby certify that on Sept 15 19 54 I surveyed the property described above and that the above plat is a correct representation of said survey.

Clyde H Parker