



EGAN, FIELD & NOWAK

SURVEYORS

2825 HARRIET AVE.

MINNEAPOLIS, MINNESOTA

CERTIFICATE OF SURVEY

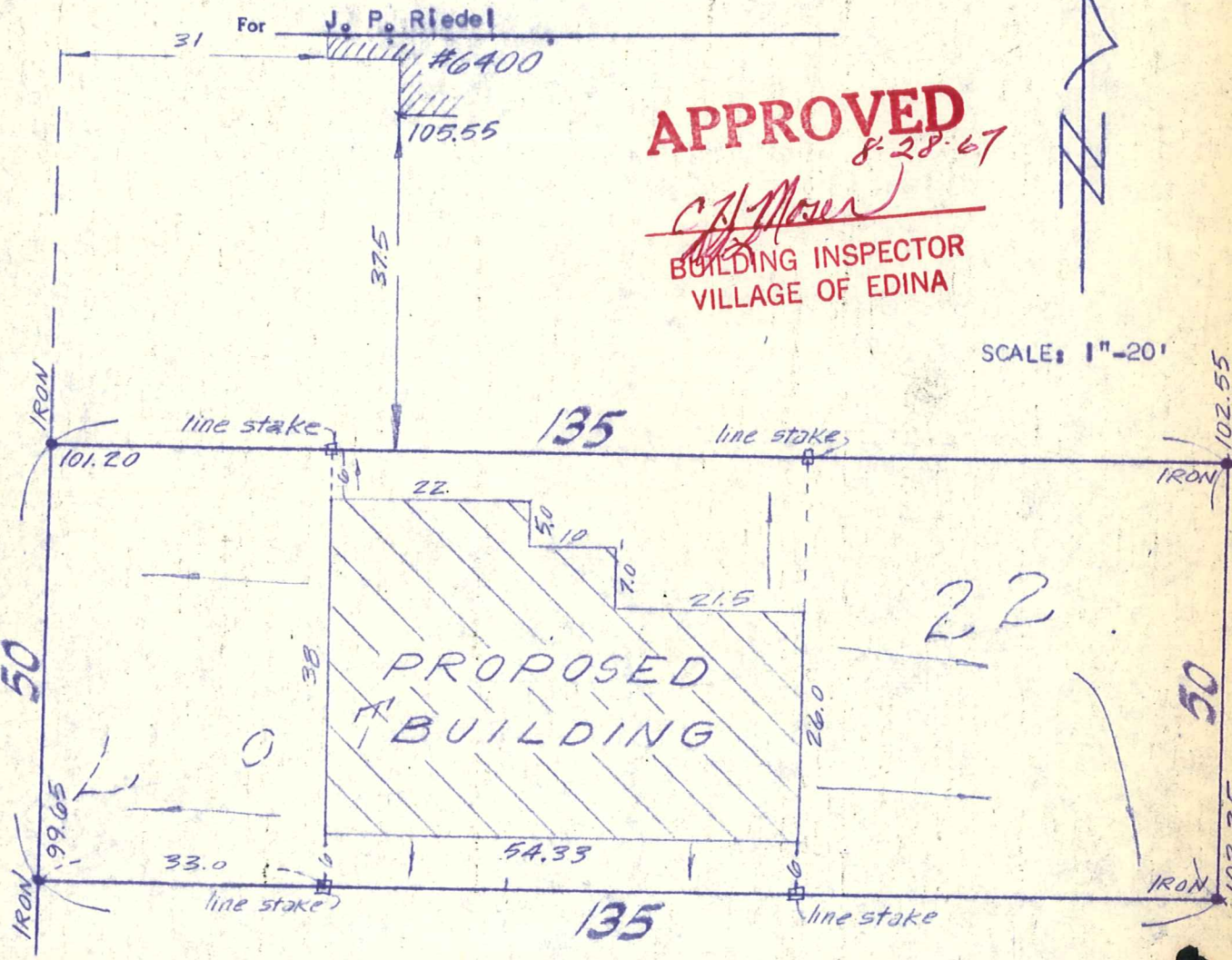

DESCRIPTION: Lot 22, Block 14,
"Normandale Second Addition"

RECEIVED AUG 25 1967

04-116-21-24-0058
6409 Josephine Ave.

We hereby certify that this is a true and correct representation of a survey of the boundaries of the land above described and of the location of all buildings, if any, thereon, and all visible encroachments, if any, from or on said land.

Dated this 17th day of August, 1967.

EGAN, FIELD & NOWAK
Surveyors

File No. 3926 Book No. 1770/50

04-116-21-24-0058