

Certificate of Survey for: **CHENOWETH BUILDERS**

BENCH MARK
 TOP OF PIPE
 ELEV. =

LOT AREA = 11,500 sq.ft.
 HOUSE AREA = 3,048 sq.ft.
 COVERAGE = 26.5%

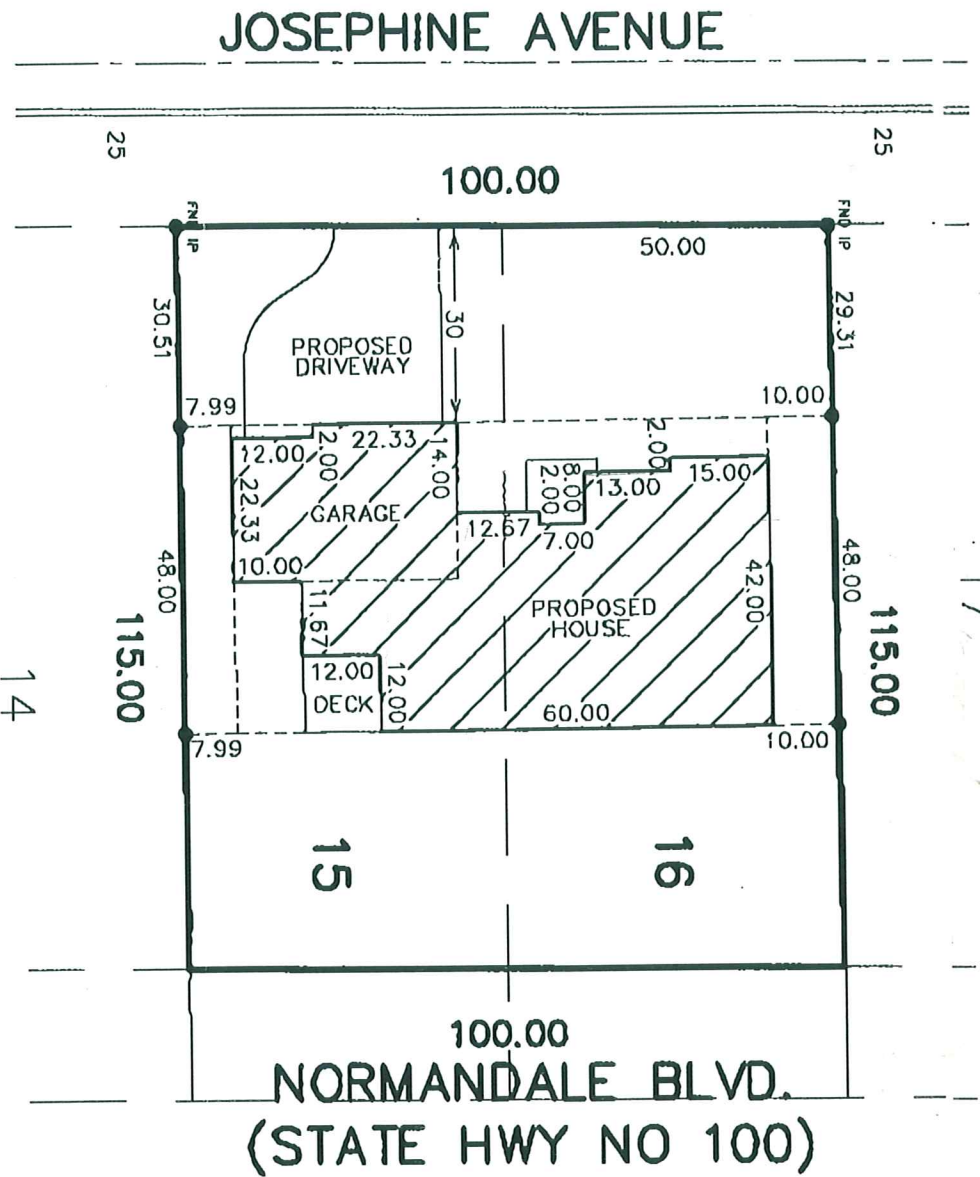

BENCH MARK
 TOP OF PIPE
 ELEV. =

NOTE: PROPOSED GRADES SHOWN PER GRADING PLAN BY:
 NOTE: BUILDING DIMENSIONS SHOWN ARE FOR HORIZONTAL AND VERTICAL LOCATION
 OF STRUCTURES ONLY, SEE ARCHITECTURAL PLANS FOR BUILDING AND
 FOUNDATION DIMENSIONS.

NOTE: NO SPECIFIC SOILS INVESTIGATION HAS BEEN COMPLETED ON THIS LOT BY THE
 SURVEYOR. THE SUITABILITY OF SOILS TO SUPPORT THE SPECIFIC HOUSE
 PROPOSED IS NOT THE RESPONSIBILITY OF THE SURVEYOR.

NOTE: THIS CERTIFICATE DOES NOT PURPORT TO SHOW EASEMENTS OTHER THAN
 THOSE SHOWN ON THE RECORDED PLAT.

NOTE: CONTRACTOR MUST VERIFY DRIVEWAY DESIGN.

NOTE: BEARINGS SHOWN ARE BASED ON AN ASSUMED DATUM

WE HEREBY CERTIFY TO CHENOWETH BUILDERS THAT THIS IS A TRUE AND CORRECT REPRESENTATION OF A
 SURVEY OF THE BOUNDARIES OF:

Lots 15 and 16, Block 15, NORMANDALE SECOND ADDITION, according to the plat
 thereof, Hennepin County, Minnesota; except the easterly 20.00 feet thereof.

IT DOES NOT PURPORT TO SHOW IMPROVEMENTS OR ENCHROACHMENTS, EXCEPT AS SHOWN, AS SURVEYED BY ME OR
 UNDER MY DIRECT SUPERVISION THIS 25TH DAY OF NOVEMBER, 1996.

SCALE : 1 INCH = 30 FEET

1715 96523.01 SWK

PROPOSED HOUSE ELEVATION

LOWEST FLOOR ELEVATION: _____

TOP OF BLOCK ELEVATION: _____

GARAGE SLAB ELEVATION: _____

- x 000.00 DENOTES EXISTING ELEVATION
- (000.00) DENOTES PROPOSED ELEVATION
- DENOTES DRAINAGE AND UTILITY EASEMENT
- DENOTES DRAINAGE FLOW DIRECTION
- DENOTES MONUMENT
- DENOTES OFFSET HUB

SIGNED: PIONEER ENGINEERING, P.A.

BY: John C. Larson, L.S. Reg. No. 19828

04-116-21-24-0106
 6525 Josephine Ave.