

CERTIFICATE OF SURVEY

Survey For: Philip Legler File No. 4083 Book 259 Page 75

AVE
100.0

TINGDALE

6533

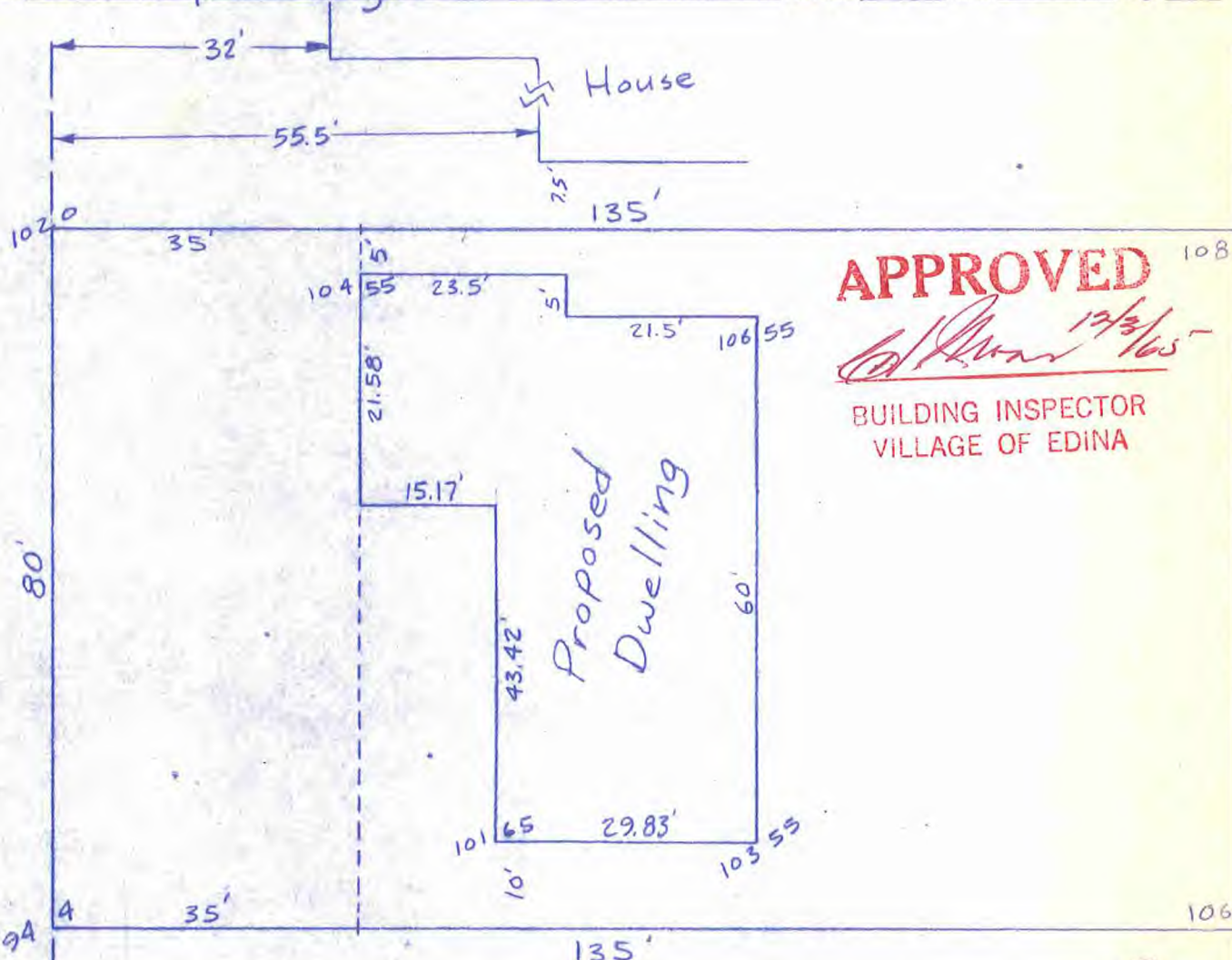

APPROVED

[Signature] 12/3/65

BUILDING INSPECTOR
VILLAGE OF EDINA

lot area = 10,800 sq ft
25% = 2700 sq ft
Dwelling = 2159 sq ft



North

Scale 1"=20'

6533 Tingdale Ave,
04.116.21.24.0072

13844

I hereby certify that this is a true and correct representation of a survey of the boundaries of Lot 16 and the South 30 feet
of Lot 17, Block 17, Normandale 2nd Add. Hennepin County, Minnesota and of the location of all buildings thereon, and all
visible encroachments, if any, from or on said land. Surveyed by me this 30th day of November, 1965

[Signature]