

CERTIFICATE OF SURVEY

Fillmore 4593 - 94 - 95

PRior 4050

RALPH D. THOMAS & ASSOCIATES INC.
ENGINEERS
400 MET. LIFE BLDG.
MINNEAPOLIS 1, MINNESOTA

6349 JOSEPHINE AVE SO. 50' R/W

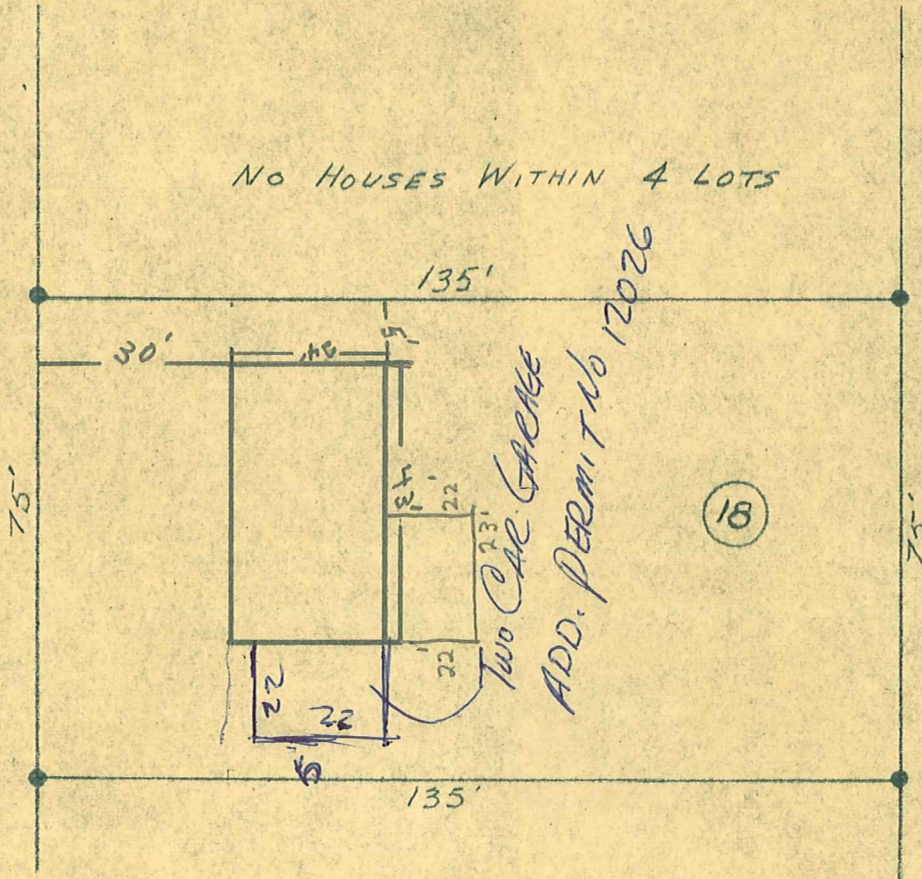

N
S
BELT LINE

● IRON
Scale: 1"=30'

We hereby certify THAT WE HAVE ON THIS 13th DAY OF OCTOBER 1952
MADE A SURVEY OF THE REAL ESTATE DESCRIBED AS LOT 18 AND THE NORTH HALF OF
LOT 17, BLOCK 1, NORMANDALE 2ND ADDITION, VILLAGE OF EDINA,
HENNEPIN COUNTY, MINNESOTA,
AS SHOWN ON THE ABOVE PLAT.

SURVEY MADE FOR IVERSON'S INV. CO.

AT THE REQUEST OF " " "

I hereby certify that this survey, plan, or report was prepared by me or under my direct supervision and that I am a duly Registered Land Surveyor under the Laws of the State of Minnesota.

04-116-21-21-0002
6349 Josephine Ave.
RALPH D. THOMAS & ASSOCIATES INC.
Engineers

Donald D. Kingley Reg. No. 3105
Minneapolis Lic. No. 7850

(SUPERSEDES 675-A87)
Project No. 675 A 164

Sheet No. 2