

CERTIFICATE OF SURVEY

Survey For: O.D. Patton

File No. 4011 Book 233 Page 48

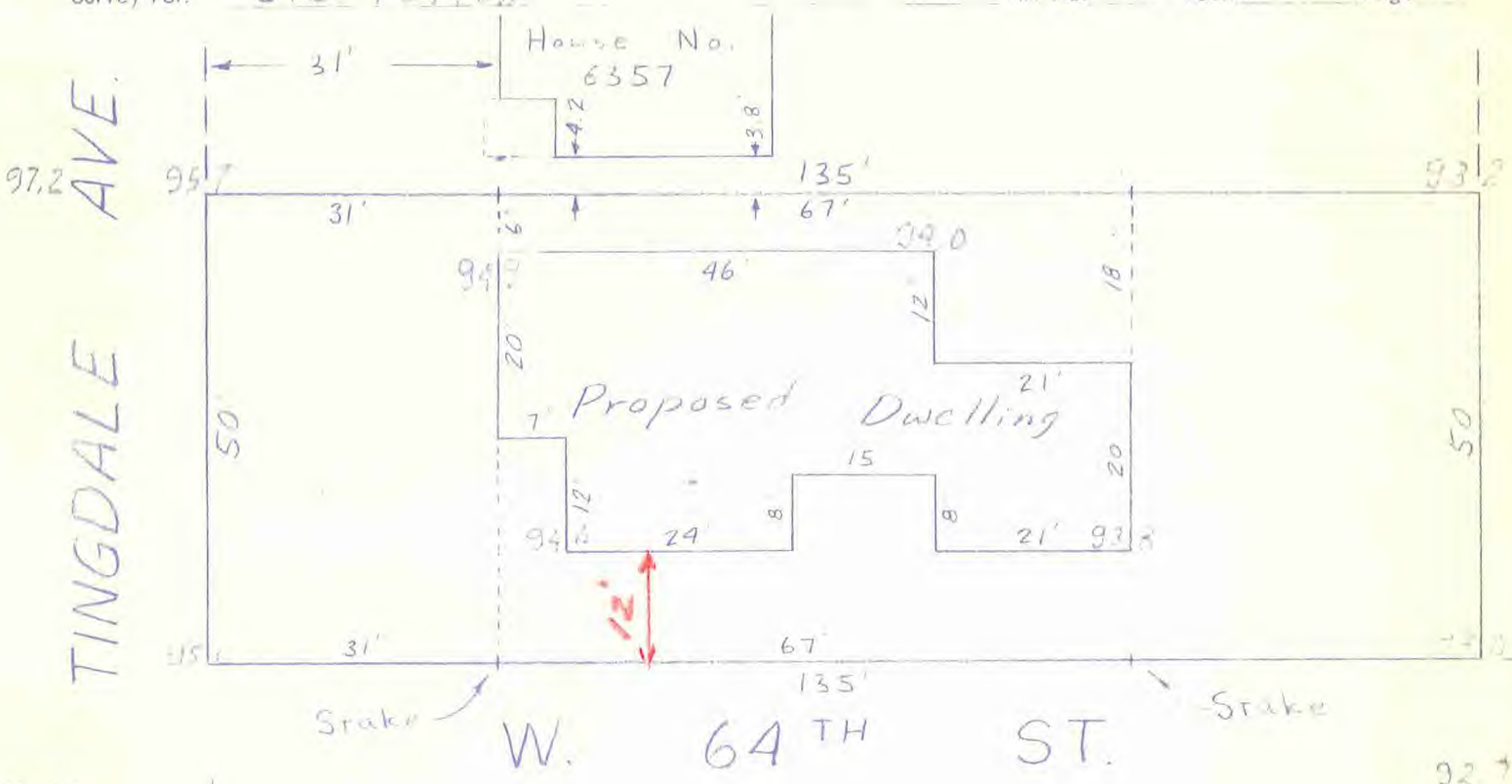

TINGDALE AVE.

W. 64TH ST.

I hereby certify that this is a true and correct representation of a survey of the boundaries of Lot 16, Block 3, Normandale, Hennepin County, Minnesota and of the location of the stakes as set for a proposed building. As surveyed by me this 6th day of December, 1960.

Scale
1" = 20'

6361 Tingdale Ave.
04.116.21.21.0030

15965